

Toyo

Wear resistant pumps with agitator

**TECHNICAL SPECIFICATIONS
GR PUMPS**

Performance curves

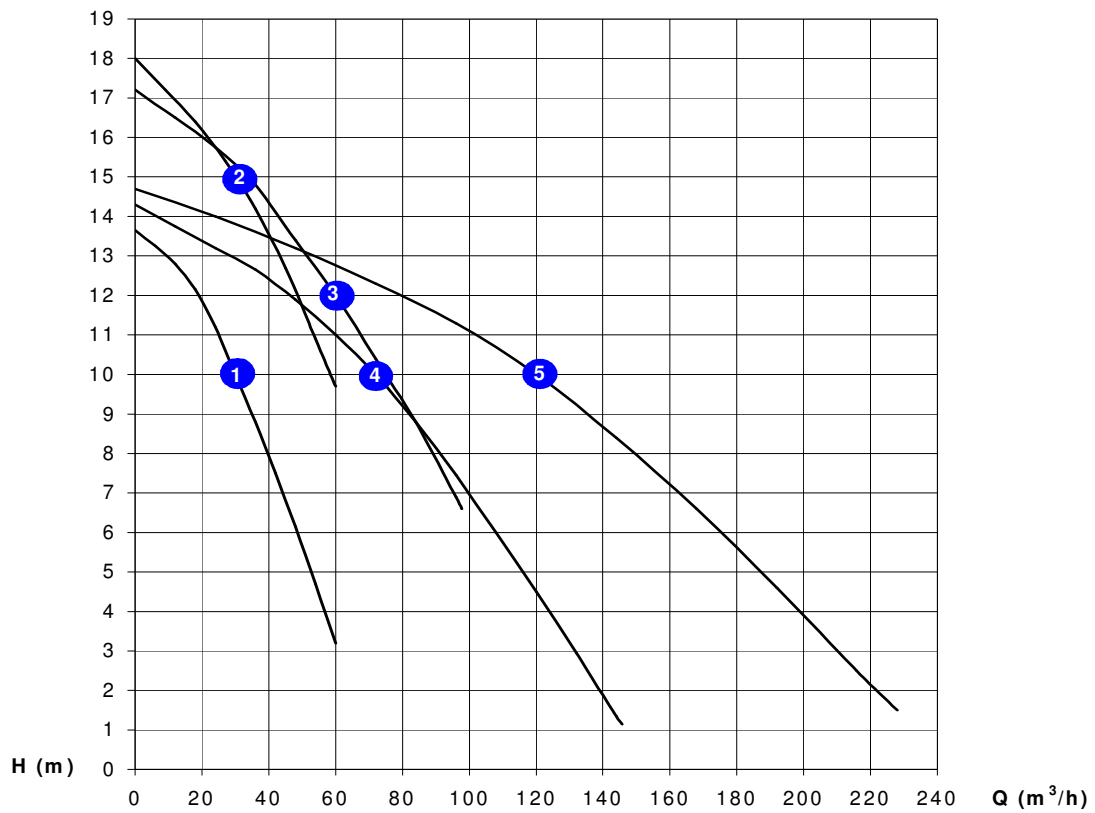

N°	Type	Outlet (inch)(mm)		Capacity (m ³ /h)	Manom. head (m)	Particle size (mm)	Power (kW)	Revolution (1/min) 50Hz	Current (A) 400 V	Electr. Cable	Weight (kg)
1	GR 3-2	3	80	30	10	22	2,2	1425	5,5	4x6mm ²	115
2	GR 5-2	3	80	30	15	22	3,7	1445	8,5	4x6mm ²	135
3	GR 7,5-2	4	100	60	12	25	5,5	1425	11	4x10mm ²	145
4	GR 10-100-2	4	100	72	10	35	7,5	1435	15	4x10mm ²	180
5	GR 10-2	6	150	120	10	35	7,5	1435	15	4x10mm ²	180

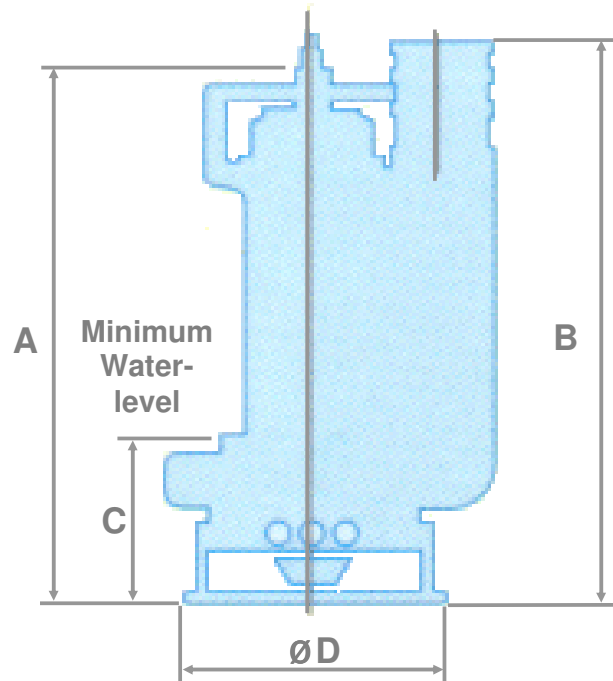
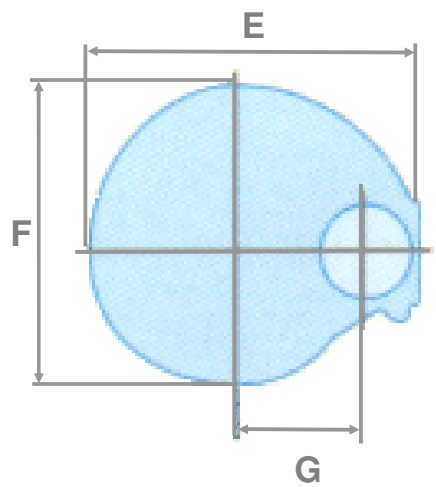

DIMENSIONS		A	B	C	D	E	F	G
1	GR 3-2	677	673	235	384	395	370	160
2	GR 5-2	742	738	235	384	395	370	160
3	GR 7,5-2	775	758	250	396	425	401	170
4	GR 10-100-2	800	843	250	396	500	450	195
5	GR 10-2	800	843	250	396	500	450	195

• **Concept :**

The TOYO GR range of submersible pumps with agitator has been specially designed to handle heavy and abrasive slurries.

These centrifugal pumps, with semi-open impeller, feature a unique agitator design. This agitator lifts sediments into suspension, creating a slurry mixture. GR pumps enable continuous pumping of sludge with a density of 1,1 kg/dm³.

Robust construction, careful selection of materials and unique contour components, have produced a pump with excellent abrasion resistance. These characteristics ensure long service life and economical operation. The impeller, the wear plates and the agitator are manufactured in cast chrome iron (24 to 28 % Cr).

A strong short shaft, supported by a series of carefully selected bearings and an assembly of special seals, ensure tightness in hardest of conditions.

The axial flow of the pumped liquid allows reducing the outer diameter of pump and hoses assembly.

The cooling of the electric class F motor is assured by environment.

Servicing the pumps and maintaining good working order is easy. One adjustable wear plate allows optimizing hydraulic efficiency of the pump.

• **Operating conditions :**

GR pumps can handle slurries with solid contents of up to 30 % by weight, particle sizes up to 35 mm and liquid temperatures up to 60°C with pH levels between 4 and 9,5.

The maximum operating depth is 30 m.

• **Electric power requirements* :**

Pumptype	Power kVA	Amp. 400 V
GR 3-2	7	5,5
GR 5-2	12	8,5
GR 7,5-2	17	11
GR 10-100-2	24	15
GR 10-2	24	15

*These figures are given as an indication.

• **Electric cable :**

The standard cable type to be used for connecting the pump is HO7RN-F and its specifications should correspond to the following :

Pumptype	Section	Outer diam. mm	Max. length m/400V
GR 3-2	4 x 6 mm ²	19	500
GR 5-2	4 x 6 mm ²	19	340
GR 7,5-2	4 x 10 mm ²	23	400
GR 10-100-2	4 x 10 mm ²	23	290
GR 10-2	4 x 10 mm ²	23	290



TOYO PUMPS EUROPE

Parc Industriel Sud - Zone II
 Rue de l'Industrie 41 - BE - 1400 Nivelles - Belgium
 Tel. : +32(0)67645537 - Fax : +32(0)67645531
 E-mail : sales@toyopumpseurope.com
 Website : www.toyopumpseurope.com

